

ASIAN WAREHOUSING LIMITED

DETAILS OF BUSINESS

Asian Warehousing Limited is engaged in the development, operation, and management of modern warehousing and logistics infrastructure designed to support efficient supply chain operations across India. The Company focuses on providing safe, organized, and technologically advanced storage facilities that help businesses optimize logistics costs and improve operational efficiency.

The Company develops integrated warehouse parks and logistics facilities with infrastructure designed for large-scale storage, efficient truck movement, and modern handling systems. These facilities are developed with a focus on operational efficiency, safety, scalability, and ease of distribution.

The Company was incorporated on May 08, 2012, under the Companies Act, 1956 as Asian Warehousing Private Limited. The Registered Office of the Company is situated in Mumbai. The Hon'ble High Court of Judicature at Bombay vide its order dated 10th April 2015 had approved the Scheme of Arrangement between RT Exports Limited ("Demerged Company") and Asian Warehousing Private Limited ("Resulting Company"). The resulting company was later converted into public limited w.e.f. 8th December 2018 and consequent to such conversion the name of the resulting company changed to ASIAN WAREHOUSING LIMITED. The Company was listed on the BSE w.e.f. 27th June 2023.

EXISTING FACILITY - BUNDI, RAJASTHAN

Our Company is engaged in the business of agricultural commodities warehousing, providing safe, efficient, and well-managed storage infrastructure for agri and food industry clients.

The Company operates a modern warehousing facility located in Bundi, Rajasthan, spread across approximately 18 acres of land. The facility has a total built-up area of approximately 232,364 sq. ft. with an aggregate storage capacity of approximately 44,440 MT, catering to various participants in the food and agricultural supply chain.

The infrastructure has been designed to support efficient logistics operations, high storage utilization, and smooth movement of goods through modern warehouse design and operational systems.

KEY ADVANTAGES

Operational Advantages

- Capacity to load/unload large fleet of trucks simultaneously
- Easy movement for 40 export containers, trailers & multi-axle trucks
- Wide internal roads with wide turning radius to avoid logjams
- Broad frontage enabling wide entry/exit points & avoidance of vehicle queuing
- High dock door ratio
- Well-designed loading/ unloading bays enabling easy manoeuvrability, parking & docking for 40 trucks & trailers
- Ample large parking bays
- Facility for forklift loading and unloading
- Capacity to load and unload a large fleet of trucks simultaneously
- Easy movement for 40-foot export containers, trailers, and multi-axle trucks
- Wide internal roads with adequate turning radius to prevent traffic congestion
- Broad frontage with multiple entry and exit points to avoid vehicle queuing
- High dock door ratio for faster loading and unloading operations
- Well-designed loading and unloading bays enabling easy maneuverability, docking, and parking for trucks and trailers
- Ample parking space for vehicles within the facility
- Forklift-enabled loading and unloading operations for efficient material handling

Quality Advantages

- Use of modern engineering materials & construction techniques
- Weatherproof PEB (Pre-Engineered Building) built with modern materials & construction techniques
- 100% leak and dampness proof roofing with skylight & ventilators
- Fireproof, wind, rain & lightning protected Galvalume sheeted roofing

- **Flat heavy duty Trimix flooring**
- **Use of modern engineering materials and advanced construction techniques**
- **Weatherproof Pre-Engineered Buildings (PEB) constructed using high-quality materials**
- **Leak-proof and dampness-resistant roofing with skylights and ventilators**
- **Fire-resistant, wind, rain, and lightning-protected Galvalume sheet roofing**
- **Heavy-duty Trimix flooring designed to support industrial loads and warehouse operations**

Economic Advantages

- **Space designed for high 'Cube' utilization**
- **Large floor plates of 60,000 square feet**
- **Warehouse clear height 28**
- **Wide Column Grids**
- **Warehouse space designed for high cube utilization, enabling efficient vertical storage**
- **Large floor plates of approximately 60,000 sq. ft. allowing flexible storage configurations**
- **Warehouse clear height of approximately 28 feet, suitable for racking systems**
- **Wide column grids, allowing optimal space utilization and smooth equipment movement**

MASTER LAYOUT PLAN

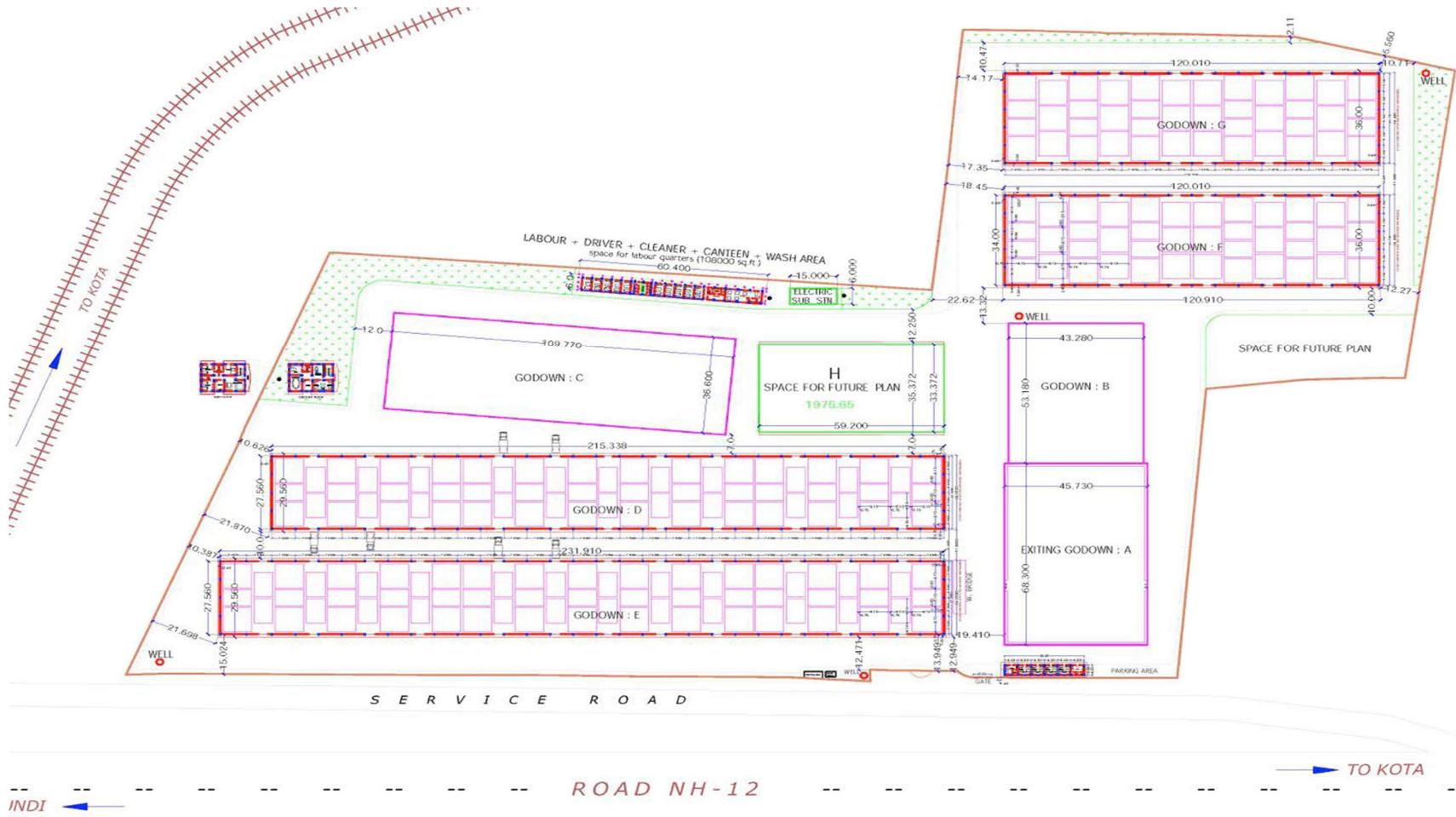

MANAGEMENT TEAM



Bhavik Bhimjyani
Chairman & Managing Director

Mr. Bhavik Rashmi Bhimjyani is the Promoter, Chairman and Managing Director of Asian Warehousing Limited. He holds a Bachelor of Science in Economics (Finance) from the Wharton School, University of Pennsylvania, and an MBA in Entrepreneurial Management from the same institution.

Early in his career, Mr. Bhimjyani worked in the Mergers and Acquisitions Group at Lazard Frères in New York, where he was involved in several significant transactions, including the sale of HotJobs to Yahoo. He also worked with the Technology Investment Banking Group at Merrill Lynch in New York, USA, gaining valuable exposure to global financial markets, corporate strategy, and investment banking.

After returning to India in 2003, Mr. Bhimjyani joined the family business and has since been actively involved in expanding and diversifying the group's business interests. With over two decades of experience across logistics and warehousing, real estate development, infrastructure, and trading businesses, he has played a key role in the growth of the Company.

At Asian Warehousing Limited, Mr. Bhimjyani provides strategic leadership and oversees the overall business direction, project development, and operational management of the Company's warehousing and logistics infrastructure. He is responsible for guiding the Company's long-term vision, including the development of modern warehousing facilities and strengthening the Company's presence in the logistics and agri-storage sector.

Asha Yogesh Dawda
Non-Executive Woman Director

Mrs. Asha Dawda is a graduate in Commerce. She has over 35 years of experience in office administration and management as well as trading & marketing of products

Sangeeta Vijay Kumar
Independent Director

Mrs. Sangeeta Vijay Kumar is a Chartered Accountant with over 15 years of extensive experience. She specializes in Statutory Audits, Direct Taxation, and Corporate Social Responsibility (CSR) & Sustainability Reporting for corporate organizations. After earning her fellowship from the Institute of Chartered Accountants of India (ICAI) in 2014, she has further strengthened her expertise by completing various certificate courses in IND AS, BRSR, and FAFD. She is also a certified Peer Reviewer by the Professional Review Board (PRB) and holds a certification in computer programming. In addition to her professional roles, she is an active thought leader and has been a guest speaker and panellist on topics such as Social Audits and the Social Stock Exchange

Yogesh Thakkar
Independent Director

Mr. Yogesh Thakkar has an overall experience of 34 years' in office administration and management as well as trading & marketing of products.